

HI-TECH TRANSMISSION ENGINEERS

Manufacturer : HI-TECH Brand Couplings

H-47 & H-58 Sector-4, DSIIDC Industrial Area, Bawana, Delhi-110039 (India)

Ph : 011-41094414 , 9312628280.

E-mail : info@hi-techcouplings.com , anubhav.hitechcouplings@gmail.com

FLEXIBLE DRIVE COUPLING

MODEL: Hydax 19, 28, 38, 48, 55, 65



- Available in Six sizes to suit 1HP to 75HP.
 - Flexible Drive Coupling consists of two gear hubs engaging in a sleeve of high grade plastic material.
 - This material has superior strength and a wide operating temperature range.
 - Couplings are easy to assemble and require no maintenance or lubrication and do not emit transmission noise.
 - Gears in the crowned-tooth form permit axial and angular Misalignment.
- Available in non-corrosive options of Stainless Steel and Nylon materials also.

ASSEMBLY PROCEDURE:

Maximum permissible angular misalignment is 1.5 degrees. Ensure that the coupling hubs easily fit on the shaft. Do not use undue force. Maintain gap between hubs as shown in sketch. Use grub screws to locate gear hubs on their respective shafts.

For shock load applications use the following formula:

$$\text{Rating} / 100 \text{ RPM of coupling} = \frac{\text{HP of application} \times 100 \times F}{\text{RPM of application}}$$

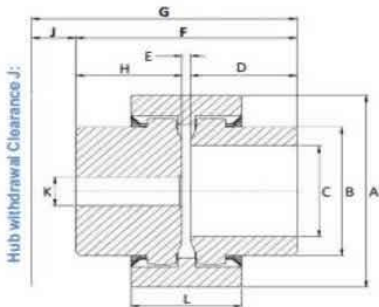

Application	Load Factor	Load Factor (F)
	El Motor	IC Engines
Uniform Load	1	1.2
Medium Shock	1.25	1.5
Heavy Shock	1.75	2.0

Coupling size	∅A	∅B	Max. ∅C	D	E	F	G	H	J	Min. ∅K	L	Pilot Bore	No of teeth
HYDAX - 19	48	30	19	25	4	54	70	25	16	7	37	7	24
HYDAX - 28	66	44	28	38	4	80	100	38	20	12	46	12	34
HYDAX - 38	83	56	38	38	4	80	104	38	24	12	48	12	44
HYDAX - 48	100	68	48	48	4	100	122	48	22	15	50	15	50
HYDAX - 55	124	82	55	60	4	124	148	60	24	15	64	15	48
HYDAX - 65	140	96	65	70	4	144	176	70	32	15	72	15	54

HI-TECH Transmission Engineers
Mobile: 9312628280