

GC SERIES
CURVED TOOTH
FLEXIBLE GEAR COUPLINGS

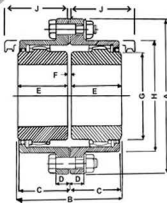

Hi-TECH FULL GEAR
GC-00 TO GC-10

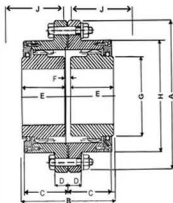

Hi-TECH FULL GEAR
GC-11 TO GC-19

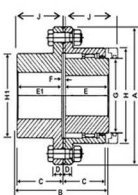

Hi-TECH HALF RIGID HALF GEAR
HRHG-00 TO HRHG-19

RATING TABLE

Coupling	Rating	Bore				Max.	
		HP/100	Gear Hub Min.	Hub Max.	Max. Rigid Hub	Torque Nm	Speed RPM
GC-00	7	15	40	50	500	7800	
GC-01	15	20	50	60	1070	6700	
GC-02	38	30	60	75	2705	5800	
GC-03	69	40	75	90	4115	4500	
GC-04	129	50	90	110	9185	3850	
GC-05	201	60	110	130	14310	3150	
GC-06	308	70	125	150	21930	2700	
GC-07	523	90	140	170	37240	2350	
GC-08	690	100	160	200	49130	2100	
GC-09	863	120	180	220	61445	1900	
GC-10	1247	140	220	260	88785	1750	
GC-11	1696	150	260	270	120755	1550	
GC-12	2144	170	300	300	152650	1400	
GC-13	3860	180	330	340	274830	1100	
GC-14	5335	230	370	370	379850	900	
GC-15	6387	250	410	400	454750	800	
GC-16	9115	300	460	460	649000	710	
GC-17	11917	350	520	530	848500	630	
GC-18	15778	380	615	580	1123400	560	
GC-19	20805	425	705	650	1481300	500	

DIMENSIONAL TABLE

Coupling	Rating	Approximate Dimensions														Weight in Kg.	GD ² Value Kg. M ²
		A	B	C	D	E	E1	F	G	H	H1	J					
GC-00	7	125	111	48	17	53	55.5	5	58	82	70	60	6	0.04			
GC-01	15	170	115	50	17	55	57.5	5	70	110	85	65	12	0.12			
GC-02	38	185	145	62	17	70	72.5	5	85	125	110	80	17	0.20			
GC-03	69	220	175	78	20	85	87.5	5	105	150	130	105	26	0.50			
GC-04	129	250	215	96	20	105	107.5	5	130	175	160	125	45	1.00			
GC-05	201	290	230	106	25	110	115	10	155	200	185	140	67	2.15			
GC-06	308	325	260	120	25	125	130	10	175	230	215	155	95	3.70			
GC-07	523	350	290	135	25	140	145	10	205	260	240	175	120	5.30			
GC-08	690	380	330	150	25	160	165	10	225	290	285	200	180	9.00			
GC-09	863	430	350	160	25	170	175	10	250	330	315	210	215	12.50			
GC-10	1247	490	380	175	25	185	190	10	310	390	370	230	320	30.80			
GC-11	1696	545	410	190	30	200	205	10	350	445	380	260	590	57.40			
GC-12	2144	590	490	230	30	240	245	10	400	490	420	290	760	89.50			
GC-13	3860	680	535	240	35	260	267.5	15	450	555	480	320	1020	140.00			
GC-14	5335	730	575	265	35	280	287.5	15	500	610	520	340	1350	291.00			
GC-15	6387	780	655	305	35	320	327.5	15	540	660	560	375	1700	353.00			
GC-16	9115	900	720	330	45	350	360	20	625	755	655	425	2550	690.00			
GC-17	11917	1000	820	385	45	400	410	20	720	855	755	460	3620	1235.00			
GC-18	15778	1100	920	430	55	450	460	20	810	950	820	510	4860	1965.00			
GC-19	20805	1250	1000	445	55	485	500	30	910	1050	920	560	6380	3012.00			

(1) Above dimensions are approximate & be used for guidance only. We reserve the right to alter these dimensions without notice.

(2) The Continuous rating values are for normal duty conditions with Service Factor 1.0

(3) All Dimensions in mm.